

## **UPPERCUT**

Portable plasma system for manual and mechanised cutting and gouging



**UPPERCUT** is a 120A portable air-plasma system with extremely high performance in relation to its low weight, the power source weighs only 18 kg and can cut up to 45mm thickness. With air plasma systems you can cut mild steel, stainless steel, aluminum, brass, copper and other electrically conductive materials.

The system is supplied for manual cutting with air-cooled hand torch PTA 121 available in lengths of 6m and 15m. For mechanized cutting system is supplied with the machine torch PTM 120 available in lengths of 6m and 12m. Full range of accessories with contact cutting shields, support carriage, circle cutting guide, etc. are available.

## **Technical data:**

Power supply	400V, 3~ 50/60Hz
Fuse	32 A slow blow
Maximum power	17,6 kVA*
Process power	120V, 20-120A
Duty cycle	30%, @ 120A 60%, @ 100A 100%, @ 80A
Power factor	0,95
Open circuit voltage	240 VDC
Protection class	IP 23
Cooling	F
Temperature class	F
Dimensions LxWxH	560x190x320
Weight	18 kg
Max cutting capacity	45 mm
Quality cutting	40 mm
Pressure/Flow	5,0 Bar / 190 l/min

\* when connected to a generator power supply the recommended minimum power of the generator is 1.5 times the maximum power of the plasma system.

## **Delivery scope:**

- Power source
- Torch PTA 121 or PTM 120 according to order
- Consumable kit
- Mains cable with CEE-connector
- Work piece cable 3m
- Air-hose
- Shoulder strap
- Users manual
- CNC interface contact (PTM 120)

## Consumables and accesories PTA 121/PTM120

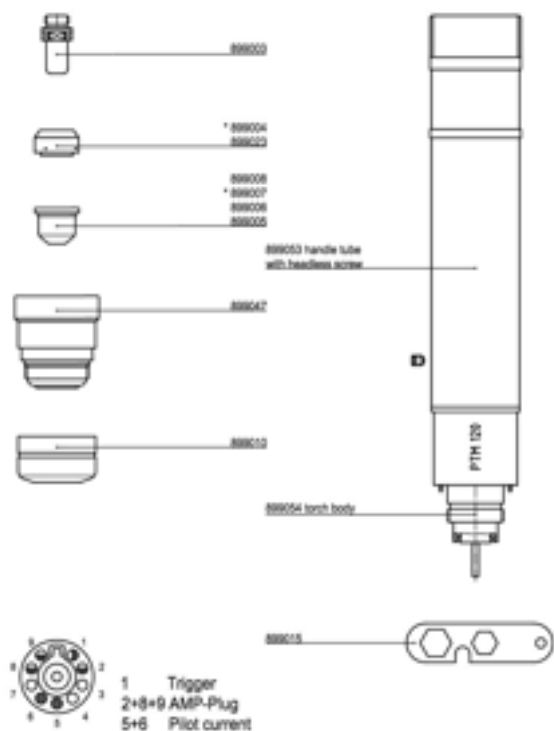
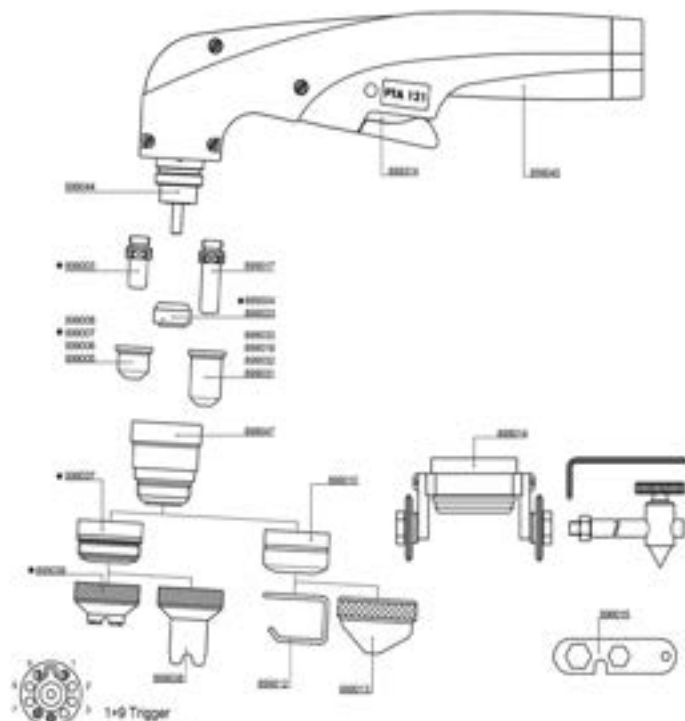

Part No.	Denomination
454042	UPPERCUT complete with 6 m PTA121
454072	UPPERCUT complete with 15m PTA121
454073	UPPERCUT complete with 6m PTM120
454074	UPPERCUT complete with 12m PTM 120
899044	Torch body PTA 121
899003	Electrode standard
899017	Electrode long
899004	Swirl ring 80-120A
899023	Swirl ring 20-80A
899005	Nozzle 1,0 20-50A
899006	Nozzle 1,2 50-90A
899007	Nozzle 1,4 90-120A
899008	Nozzle 1,6 120A
899031	Nozzle 1,0 20-50A long
899032	Nozzle 1,2 50-90A long
899018	Nozzle 1,4 90-120A long
899033	Nozzle 2,5 gouging long
899047	Protective cup
899010	Spatter shield
899037	Spatter shield, threaded
899036	Contact cutting shield, threaded
899012	Distance cutting guide
899013	Bevel cutting guide
899038	Contact cutting shield, threaded
899014	Circle cutting guide PTA 120/121
899045	Handle PTA 121
899314	Button PTA 121
899049	Hoseparcel PTA 121 6m
899050	Hoseparcel PTA 121 15m
899015	Consumable tool
899040	Torch PTA 121 6m complete
899041	Torch PTA 121 15m complete
899053	Handle PTM 120
899054	Torch body PTM 120
899057	Hoseparcel PTM 120 6m
899058	Hoseparcel PTM 120 12m
899051	Torch PTM 120 6m complete
899052	Torch PTM 120 12m complete

SPT Plasmatechnik AB was founded in 1987 by engineers in the field of plasma cutting. The company is located in Eslöv, about 45 minutes from Copenhagen Airport.

With over 25 years experience in plasma cutting, we have a solid knowledge of how to make the best use of plasma cutting and gouging. With a wide product range SPT can offer systems for manual, mechanized and robotic plasma cutting that meet the needs of every application.

For more information, contact us by phone +46-10 172 73 50 or send an email to [info@spt.se](mailto:info@spt.se). On our website [www.spt.se](http://www.spt.se) you will find more information about our products and where you can find our distributors.



**SPARCIN 9C** Portable plasma cutting system **with integrated compressor.**

*The only plasma system on the market equipped with built-in compressor, for hand-held plasma cutting with capacity to cut over 20mm of material thickness and yet portable weighing less than 30 kg!*



Suitable for service and maintenance workshops, construction companies and metalworking companies that want a complete plasma device for cutting and gouging in different types of conductive materials up to 25mm thickness. The built in compressor comes well in place where there are requirements for mobility or lack of access to dry, clean and oil-free compressed air.

SPT's unique water-cooled torch provides a good overall economy through efficient cooling of the consumable parts and is also a necessity to achieve this cutting capacity equipped with a built-in compressor still being a portable machine.

SPARCIN 9C can be equipped with 6 meter or 12 meter Duracut hand torch and there are a full accessories program with cutter carriage, circular cutting device and more available. The IP23S classification makes it suitable for outdoor use as well.



## Technical data:

Power supply	400V 3~ 50/60Hz
Fuse	16A slow blow
Maximum power	12 kVA*
Process power	20-80A 120V
Duty cycle	60 %
Power factor	0,95
Open circuit voltage	240 VDC
Protection class	IP 23S
Cooling	F
Temperature class	F
Dimensions LxWxH	550x300x460mm
Weight	28 kg
Max cutting capacity	25 mm
Quality cut	20 mm
Pierce	12 mm
Pressure/flow	Integrated compressor

\* when connected to a generator power supply the recommended minimum power of the generator is 1.5 times the maximum power of the plasma system.



SPT Plasmateknik AB was founded in 1987 by engineers in the field of plasma cutting. The company is located in Eslöv, about 45 minutes from Copenhagen Airport.

With over 30 years experience in plasma cutting, we have a solid knowledge of how to make the best use of plasma cutting and gouging. With a wide product range SPT can offer systems for manual, mechanized and robotic plasma cutting that meet the needs of every application. For more information, contact us by phone +46-46-184800 or send an email to [info@spt.se](mailto:info@spt.se). On our website [www.spt.se](http://www.spt.se) you will find more information about our products and where you can find our distributors.

## CIRCLE CUTTING ATTACHMENT CUTTING WAGON

FOR SPARCUT XL AND DURACUT

As accessories for the water cooled torches DURACUT and SPARCUT XL circle cutting attachments and cutting wagons are available. The cutting wagon is supplied in a two wheel version.

The wagon has a threaded bolt in the side, where an axle can be attached in order to cut greater radius' than possible with the circle cutting attachment.



The circle cutting attachment is very easy to work with. Simply snap in the torch in the holder and adjust the centrepiece to the correct radius. The torch can rotate in its holder, which helps the operator to complete a full circle without having to stop and change grip.

The circle cutting attachment is suitable for cutting radius' between 100 and 450 mm.



### Ordering information:

Part no	Denomination
299028	Cutting wagon for SPARCUT XL, two wheel
299030	Cutting wagon for DURACUT, two wheel
299079	Circle cutting attachment for DURACUT
299082	Circle cutting attachment for SPARCUT XL

## **SPARCIN 9**

Multi plasma system for cutting and gouging



**SPARCIN 9** is a highly efficient multi-plasma system with water-cooled torch for all types of industrial plasma cutting and gouging up to 25mm.

The water-cooled torch provides a good overall economy through the efficient cooling of the consumables, low gas consumption and the ability to use technical specialty gases for cutting and gouging, to optimize cut quality and minimize the need for post-processing before welding.

SPARCIN 9 can be equipped with 6, 12 or 20m Duracut hand torch for manual cutting and gouging. For mechanized applications SPARCIN 9 can be equipped with up to 20m long machine torch Sparcut XL / M or Bazocut. Full range of accessories with the cutting support carriage, circle cutting guide, etc. are available.



## **SPARCIN 9C**

Portable plasma cutting system with integrated compressor.



**SPARCIN 9C** is a portable plasma systems with water-cooled torch and built-in compressor for plasma cutting and gouging up to 20mm. With its built-in compressor is SPARCIN 9C developed for the mobile needs such as during service / maintenance or in places where access to compressed air is not available.

SPARCIN 9C can be equipped with 6 or 12m Duracut hand torch for manual cutting and gouging. Full range of accessories with the cutting support carriage, circle cutting guide, etc. are available.

## Technical data:

Power supply	400V 3~ 50/60Hz	
Fuse	16A slow blow	
Maximum power	12 kVA*	
Process power	20-80A 120V	
Duty cycle	60 %	
Power factor	0,95	
Open circuit voltage	240 VDC	
Protection class	IP 23S	
Cooling	F	
Temperature class	F	
Dimensions LxWxH	SPARCIN 9	550x300x310
	SPARCIN 9C	550x300x460
Weight	SPARCIN 9	22 kg
	SPARCIN 9C	28 kg
Max cutting capacity	25 mm	
Quality cut	20 mm	
Pressure/flow	SPARCIN 9	4,5 Bar / 18-20 l/min
	SPARCIN 9C	Integrated compressor

\* when connected to a generator power supply the recommended minimum power of the generator is 1.5 times the maximum power of the plasma system.

SPT Plasmatechnik AB was founded in 1987 by engineers in the field of plasma cutting. The company is located in Eslöv, about 45 minutes from Copenhagen Airport.

With over 25 years experience in plasma cutting, we have a solid knowledge of how to make the best use of plasma cutting and gouging. With a wide product range SPT can offer systems for manual, mechanized and robotic plasma cutting that meet the needs of every application.

For more information, contact us by phone +46-10 172 73 50 or send an email to [info@spt.se](mailto:info@spt.se). On our website [www.spt.se](http://www.spt.se) you will find more information about our products and where you can find our distributors.



## ***SPEEDFIRE***

Portable plasma system for manual and mechanised cutting and gouging



**SPEEDFIRE** is a 100A portable air-plasma system with extremely high performance in relation to its low weight, the power source weighs only 17 kg and can cut up to 35mm thickness. With air plasma systems you can cut mild steel, stainless steel, aluminum, brass, copper and other electrically conductive material.

The system is supplied for manual cutting with air-cooled hand torch PTA 121 available in lengths of 6m and 15m. For mechanized cutting system is supplied with the machine torch PTM 120 available in lengths of 6m and 12m. Full range of accessories with contact cutting shields, support carriage, circle cutting guide, etc. are available.

## Technical data:

Power supply	400V, 3~ 50/60Hz
Fuse	32 A slow blow
Maximum power	14,5 kVA*
Process power	120V, 20-100A
Duty cycle	40%, @ 100A 60%, @ 80A 100%, @ 70A
Power factor	0,95
Open circuit voltage	240 VDC
Protection class	IP 23
Cooling	F
Temperature class	F
Dimensions LxWxH	560x190x320
Weight	17 kg
Max cutting capacity	35 mm
Quality cutting	30 mm
Pressure/Flow	5,0 Bar / 190 l/min

\* when connected to a generator power supply the recommended minimum power of the generator is 1.5 times the maximum power of the plasma system.

## Delivery scope:

- Power source
- Torch PTA 121 or PTM 120 according to order
- Consumable kit
- Mains cable with CEE-connection
- Work piece cable 3m
- Air-hose
- Shoulder strap
- Users manual
- CNC interface contact (PTM 120)



## Consumables and accesories PTA 121/PTM120

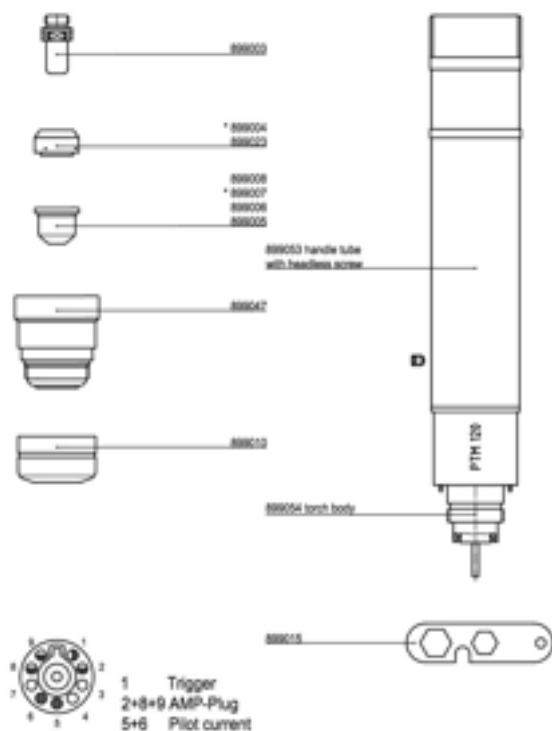
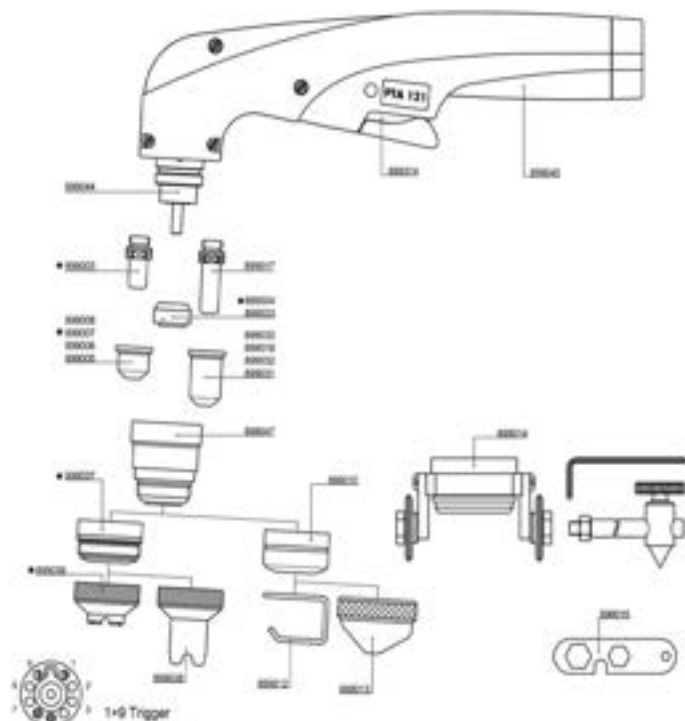

Part No.	Denomination
454053	SPEEDFIRE complete with 6 m PTA121
454069	SPEEDFIRE complete with 15m PTA121
454070	SPEEDFIRE complete with 6m PTM120
454071	SPEEDFIRE complete with 12m PTM 120
899044	Torch body PTA 121
899003	Electrode standard
899017	Electrode long
899004	Swirl ring 80-120A
899023	Swirl ring 20-80A
899005	Nozzle 1,0 20-50A
899006	Nozzle 1,2 50-90A
899007	Nozzle 1,4 90-120A
899008	Nozzle 1,6 120A
899031	Nozzle 1,0 20-50A long
899032	Nozzle 1,2 50-90A long
899018	Nozzle 1,4 90-120A long
899033	Nozzle 2,5 gouging long
899047	Protective cup
899010	Spatter shield
899037	Spatter shield, threaded
899036	Contact cutting shield, threaded
899012	Distance cutting guide
899013	Bevel cutting guide
899038	Contact cutting shield, threaded
899014	Circle cutting guide PTA 120/121
899045	Handle PTA 121
899314	Button PTA 121
899049	Hoseparcel PTA 121 6m
899050	Hoseparcel PTA 121 15m
899015	Consumable tool
899040	Torch PTA 121 6m complete
899041	Torch PTA 121 15m complete
899053	Handle PTM 120
899054	Torchbody PTM 120
899057	Hoseparcel PTM 120 6m
899058	Hoseparcel PTM 120 12m
899051	Torch PTM 120 6m complete
899052	Torch PTM 120 12m complete

SPT Plasmatechnik AB was founded in 1987 by engineers in the field of plasma cutting. The company is located in Eslöv, about 45 minutes from Copenhagen Airport.

With over 25 years experience in plasma cutting, we have a solid knowledge of how to make the best use of plasma cutting and gouging. With a wide product range SPT can offer systems for manual, mechanized and robotic plasma cutting that meet the needs of every application.

For more information, contact us by phone +46-10 172 73 50 or send an email to [info@spt.se](mailto:info@spt.se). On our website [www.spt.se](http://www.spt.se) you will find more information about our products and where you can find our distributors.



## ***SPLITFIRE***

Portable plasma system for manual and mechanised cutting and gouging



**SPLITFIRE** is a 80A portable air-plasma system with extremely high performance in relation to its low weight, the power source weighs only 17 kg and can cut up to 25mm thickness. With air plasma systems you can cut mild steel, stainless steel, aluminum, brass, copper and other electrically conductive materials.

The system is supplied for manual cutting with air-cooled hand torch PTA 121 available in lengths of 6m and 15m. For mechanized cutting system, is supplied with the machine torch PTM 120 available in lengths of 6m and 12m. Full range of accessories with contact cutting shields, support carriage, circle cutting guide, etc. are available.

## **Technical data:**

Power supply	400V, 3~ 50/60Hz
Fuse	16 A slow blow
Maximum power	12 kVA*
Process power	120V, 20-80A
Duty cycle	50%, @ 80A 60%, @ 70A 100%, @ 50A
Power factor	0,95
Open circuit voltage	240 VDC
Protection class	IP 23
Cooling	F
Temperature class	F
Dimensions LxWxH	560x190x320
Weight	17 kg
Max cutting capacity	25 mm
Quality cut	20 mm
Pressure/flow	4,5 Bar / 160 l/min

\* when connected to a generator power supply the recommended minimum power of the generator is 1.5 times the maximum power of the plasma system.

## **Delivery scope:**

- Power source
- Torch PTA 121 or PTM 120 according to order
- Consumable kit
- Mains cable with CEE-connection
- Work piece cable 3m
- Air-hose
- Shoulder strap
- Users manual
- CNC interface contact (PTM 120)

## Consumables and accesories PTA 121/PTM120

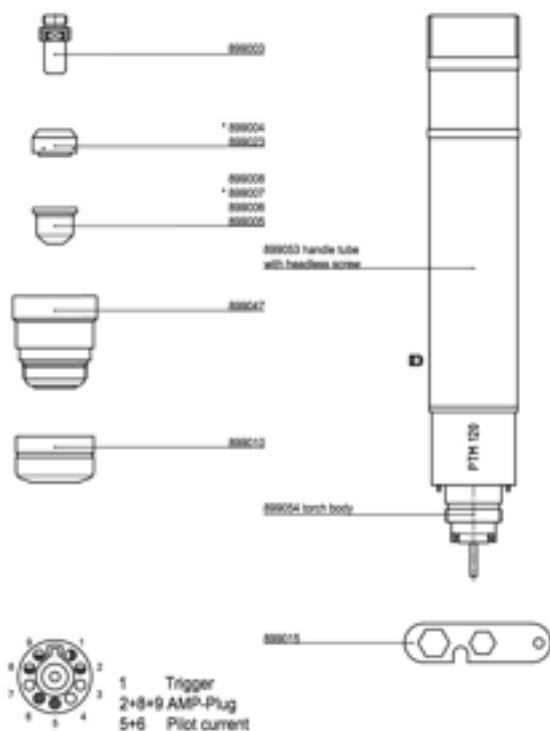
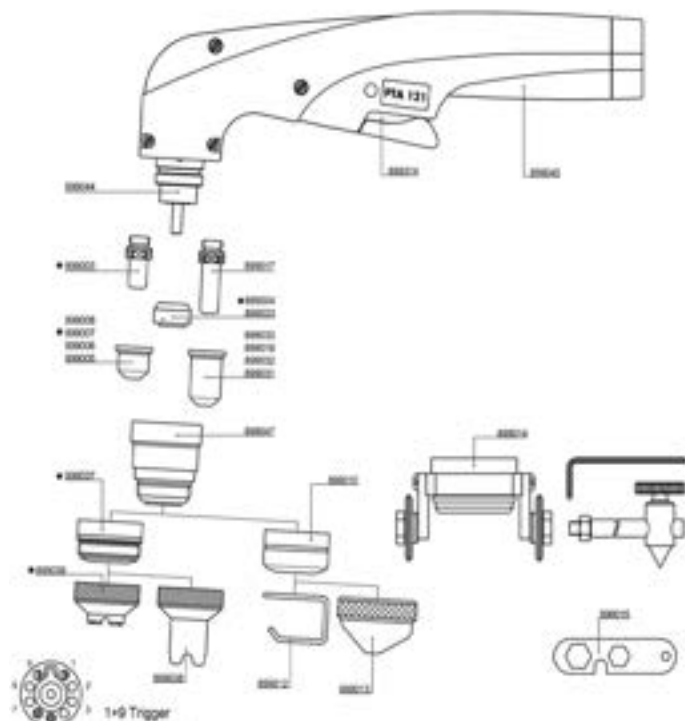

Part No.	Denomination
454045	SPLITFIRE complete with 6 m PTA121
454066	SPLITFIRE complete with 15m PTA121
454067	SPLITFIRE complete with 6m PTM120
454068	SPLITFIRE complete with 12m PTM 120
899044	Torch body PTA 121
899003	Electrode standard
899017	Electrode long
899004	Swirl ring 80-120A
899023	Swirl ring 20-80A
899005	Nozzle 1,0 20-50A
899006	Nozzle 1,2 50-90A
899007	Nozzle 1,4 90-120A
899008	Nozzle 1,6 120A
899031	Nozzle 1,0 20-50A long
899032	Nozzle 1,2 50-90A long
899018	Nozzle 1,4 90-120A long
899033	Nozzle 2,5 gouging long
899047	Protective cup
899010	Spatter shield
899037	Spatter shield, threaded
899036	Contact cutting shield, threaded
899012	Distance cutting guide
899013	Bevel cutting guide
899038	Contact cutting shield, threaded
899014	Circle cutting guide PTA 120/121
899045	Handle PTA 121
899314	Button PTA 121
899049	Hoseparcel PTA 121 6m
899050	Hoseparcel PTA 121 15m
899015	Consumable tool
899040	Torch PTA 121 6m complete
899041	Torch PTA 121 15m complete
899053	Handle PTM 120
899054	Torchbody PTM 120
899057	Hoseparcel PTM 120 6m
899058	Hoseparcel PTM 120 12m
899051	Torch PTM 120 6m complete
899052	Torch PTM 120 12m complete



SPT Plasmatechnik AB was founded in 1987 by engineers in the field of plasma cutting. The company is located in Eslöv, about 45 minutes from Copenhagen Airport.

With over 25 years experience in plasma cutting, we have a solid knowledge of how to make the best use of plasma cutting and gouging. With a wide product range SPT can offer systems for manual, mechanized and robotic plasma cutting that meet the needs of every application.

For more information, contact us by phone +46-10 172 73 50 or send an e-mail to [info@spt.se](mailto:info@spt.se). On our website [www.spt.se](http://www.spt.se) you will find more information about our products and where you can find our distributors.



# ***SPLITFIRE/SPEEDFIRE/UPPERCUT***

Air plasma systems for manual and mechanized cutting and gouging



**SPLITFIRE, SPEEDFIRE** and **UPPERCUT** are portable air-plasma systems with extremely high performance in relation to their low weight, the power sources with 80, 100 and 120A only weighs 17-18 kg and cut up to 25, 35 and 45mm thickness.

With air plasma systems you can cut mild steel, stainless steel, aluminum, brass, copper and other electrically conductive materials.

The systems are supplied for manual cutting with air-cooled hand torch PTA 121 available in lengths of 6m and 15m. For mechanized cutting system is supplied with the machine torch PTM 120 available in lengths of 6m and 12m. Full range of accessories with contact cutting shields, cut support carriage, circle cutter, etc. are available.

Technical data:	SPLITFIRE	SPEEDFIRE	UPPERCUT
Power supply	400V, 3~ 50/60Hz	400V, 3~ 50/60Hz	400V, 3~ 50/60Hz
Fuse	16 A slow blow	32A slow blow	32A slow blow
Maximum power	12 kVA*	14,5kVA*	17kVA*
Process power	120V, 20-80A	120V, 20-100A	120V, 20-120A
Duty cycle	50%, @ 80A 60%, @ 70A 100%, @ 50A	40%, @100A 60%, @80A 100%, @70A	30%, @ 120A 60%, @ 100A 100%, @ 80A
Power factor	0,95	0,95	0,95
Open circuit voltage	240 VDC	240VDC	240VDC
Protection class	IP 23	IP23	IP23
Cooling	F	F	F
Temperature class	F	F	F
Dimensions LxWxH	560x190x320	560x190x320	560x190x320
Weight	17 kg	17 kg	18 kg
Max cutting capacity	25 mm	35 mm	45 mm
Quality cut	20 mm	30mm	40 mm
Pressure/flow	4,5 Bar / 160 l/min	5,0 Bar / 190 l/min	5,0 Bar / 190 l/min

\* when connected to a generator power supply the recommended minimum power of the generator is 1.5 times the maximum power of the plasma system.

## Delivery scope:

- Power source
- Torch PTA 121 or PTM 120 according to order
- Consumable kit
- Mains cable with CEE-connection
- Work piece cable 3m
- Air-hose
- Shoulder strap
- Users manual
- CNC interface contact (PTM 120)